

MotorGuide REPAIR PARTS

Model: **POWER plus**
T62V

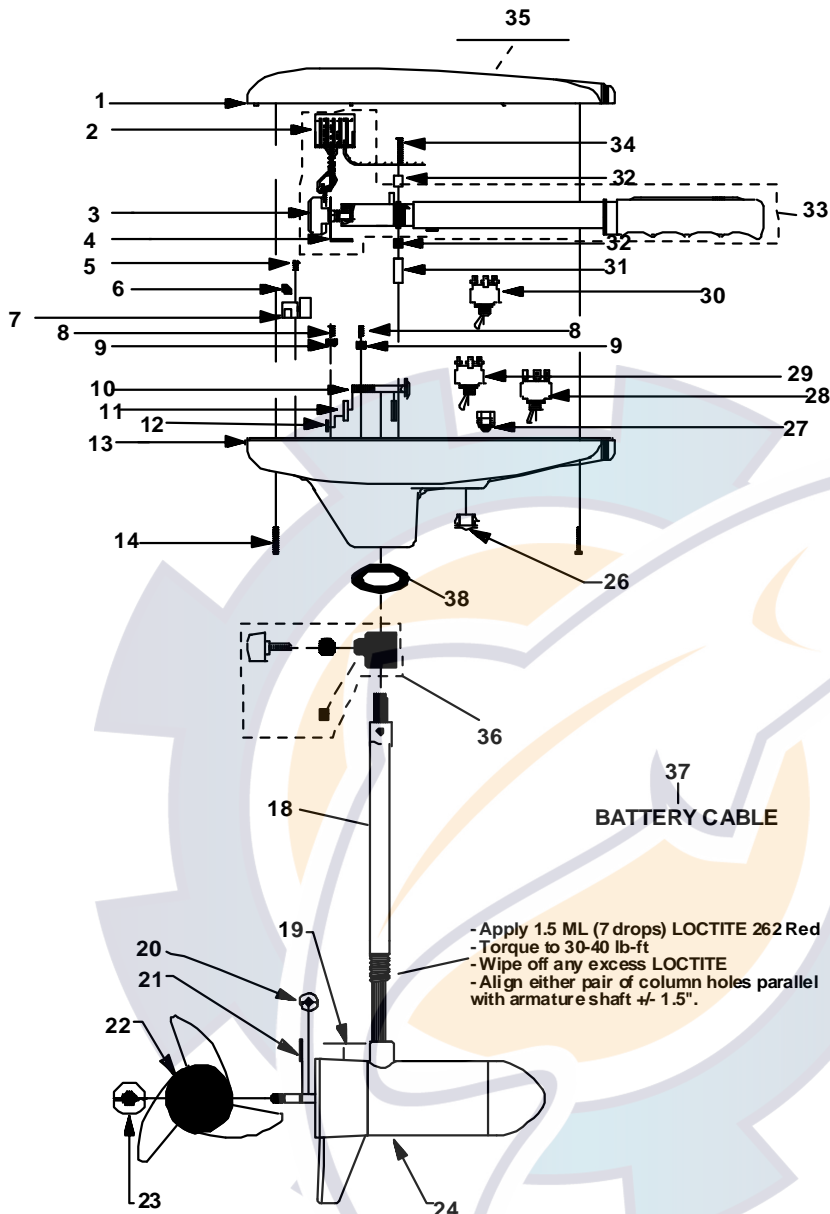

SPECIFICATIONS:

Year of Intro 1998
 Thrust 62 LBS
 Volts 24VDC
 Amp Draw 0 to 33 amps
 Mount 20 Bow
 Speeds Variable

QUICK REFERENCE PARTS GUIDE:

FOR/REV Switch FP153-06
 DA Board JF157-02
 MOSFET JF096-07
 Motor Seal Kit 6220

PARTS ORDERING & TECH ASSISTANCE

MotorGuide Consumer Relations
 Phone 918-831-6989
 Fax 800-982-8093

Send Returned Goods to:

MotorGuide
 605 Hwy 12 West
 Starkville, MS 39760

Returned Goods must be accompanied with a Returned Goods Authorization. Contact MotorGuide Consumer Relations to obtain RGA.

| KEY | DESCRIPTION | PART # | KEY | DESCRIPTION | PART # |
|-----|---------------------------|----------|-----|----------------------------|----------|
| 1 | TOP HOUSING COVER BLACK | AT053-10 | 26 | HOLE PLUG | FP021-03 |
| 2 | AMP CONNECTOR | AP029-01 | 27 | GROMMET | GR019-03 |
| 3 | POTENTIOMETER | AP168-02 | 28 | TOGGLE SWITCH 3 POSITIONS | FP153-05 |
| 4 | POT BRACKET | AT155-03 | 29 | FWD/REV SWITCH 2 POSITIONS | FP153-06 |
| 5 | SELF TAPPING SCREW | AF141-01 | 30 | | |
| 6 | INSULATING SLEEVE | AT080-01 | 31 | WIRE BRACKET | AT155-04 |
| 7 | 24 VOLT DURA AMP BOARD | JF157-02 | 32 | RETAINER CLAMP | AR036-01 |
| 8 | #10 X 1/2" SCREW | GR133-01 | 33 | HANDLE ASY | AT372-03 |
| 9 | TERMINAL BLOCK | FT160-01 | 34 | 8 X 1-3/8 SCREW | AR133-01 |
| 10 | BOLT | TT134-01 | 35 | NOMENCLATURE | JT056-07 |
| 11 | CURVED WASHER | TT171-04 | 36 | DEPTH COLLAR ASY | AR158-01 |
| 12 | NYLON LOCK NUT | XT098-02 | 37 | BATTERY CABLE | BT328-03 |
| 13 | T/H BASE BLACK | AR004-14 | 38 | COLUMN SEAL | AT079-01 |
| 14 | SCREW #8 X 1" | LF141-04 | | | |
| 15 | BAR KNOB DEPTH ADJUSTMENT | AR082-02 | | | |
| 16 | COLUMN CLAMP WASHER | AR171-01 | | | |
| 17 | COLUMN SUPPORT NUT | FR098-01 | | | |
| 18 | COLUMN 42" | FR049-15 | | | |
| | COLUMN 50" | FR049-13 | | | |
| 19 | LOWER UNIT DECAL | ET060-04 | | | |
| 20 | MONOFILAMENT WASHER | AR175-01 | | | |
| 21 | PROP DRIVE PIN | BR102-01 | | | |
| 22 | PROP/3 BLADE | AF124-10 | | | |
| 23 | PROP NUT | AR099-01 | | | |
| 24 | H/O MOTOR | UF397-01 | | | |
| 25 | DEPTH ADJUSTMENT COLLAR | AR051-01 | | | |

Model:
T62V

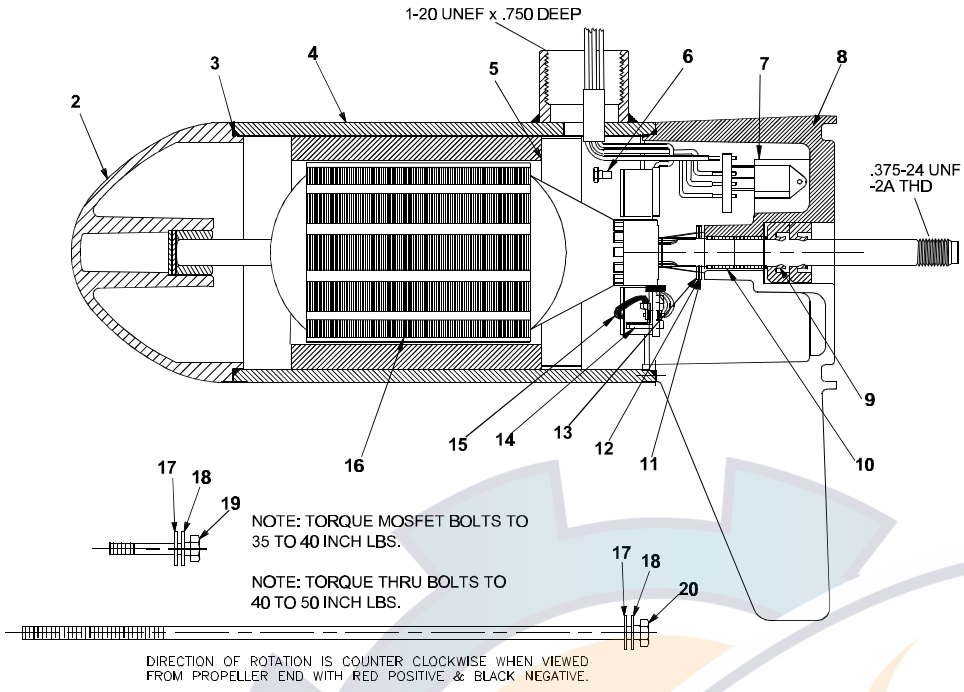

WIRING

12V OR 24V D.A. WIRING DIAGRAM

SUBJECT TO DAMAGE BY STATIC ELECTRICITY ASSEMBLE AT STATIC FREE WORK STATION.

